

1	2	3	4	5	6	7	8	9	
版本:A0	区域	修改内容	公差等级(未注)	发行日期					
			GB/T1804-2000 f级	2016-04-02					

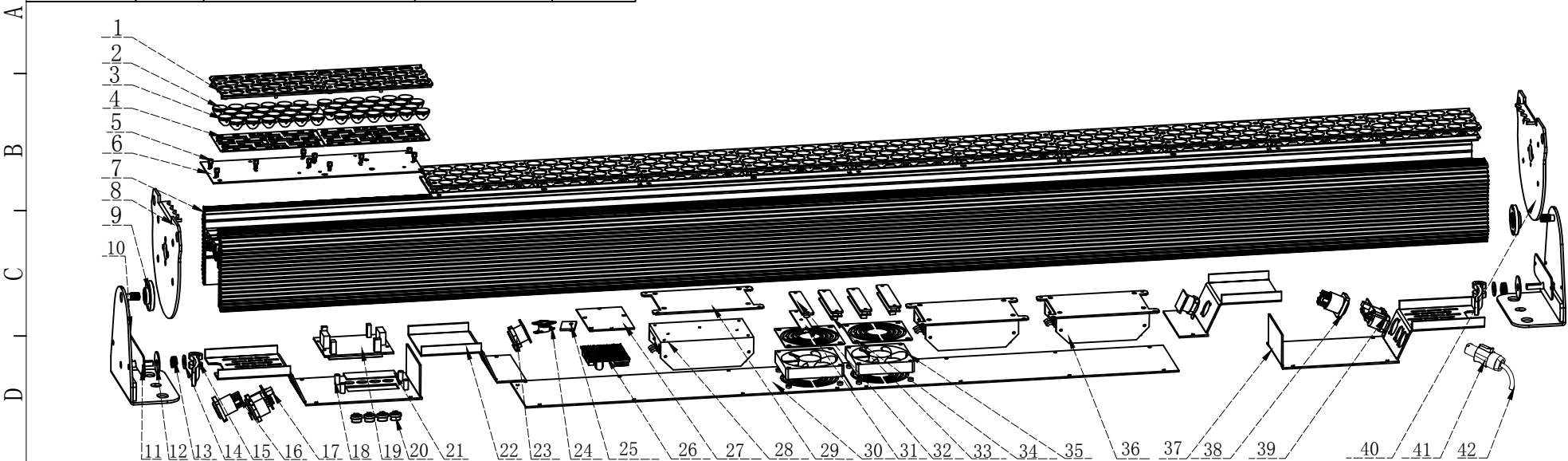

SN.	PART CODE	DRAFT NO.	ITEM NO.	QTY
1	703010011A	LA2115-5-01	the fixing plate for lens	12
2	5050100034	DB013A	lens (small degree)	144
3	5050100035	DB013B	lens (large degree)	144
4	7030100112	LA2115-3-02	base plate	12
5	7020300040		copper pillar	60
6	8010058900	L20104-03A-001	LED PCB	6
7	7040100050A	LA2115-01	light housing	1
8	7010200912A	LA2115-09	the side plate(left)	1
9	7050000052	LA2115-11	bearing assembly	2
10	7010200911A	LA2115-08-00	light shelf assembly	2
11	6120300000	LA2115-13	plastic clip	2
12	7020200042		flat washer	2
13	7020201015		spring washer	2
14	7020200041		flat washer	2
15	7040100051A	LA2115-1-13	handle	2
16	6120200000	NAC3MPA-1	powercon in	1
17	8010027503	LADMV-11-004	DMX IN	1
18	7010200903A	LA2115-02	the fixing plate for male sockets	1
19	8010046600	LA2115-02A-001	display PCB	1
	8060140000	CPCS0400-1101-001	software	
20	7030100057		button	4
21	5070100005		PC for display	1
22	7010200905A	LA2115-04	the fixing plate for network plug	2
23	8010040400	LARJ45-03A-001	network socket PCB	2
24	6060400000	KSD301 90°C	temp. control switcher	1
25	8010046900	LA4121-04A-001	temp. control PCB	1
	8010046501	LAETW-01A-001	network PCB	
26	8060040000	CPCS0400-5001-001	software	1
27	7010200909	LA2115-12	adapter plate for PSU	1
28	5040000099	K18-UP400S24	PSU	2
29	7010200907	LA2115-07	fixing plate for PSU	3
30	7010200906A	LA2115-05	fan plate	2
31	8010046800	LA2115-07A-001	adapter plate for fans	1
32	7010200910	LA2115-20	the fixing plate for adapter plate	4
33	8010046700	LA2115-08B-001	adapter plate for PSU	3
34	7010200908	LA3741-06	fan plate	2
35	5010000012	DF38015B	fan	2
36	5040000100	K18N-UP200S24	PSU	1
37	7010200904A	LA2115-03	the fixing plate female sockets	1
38	6120300000	NAC3MPB-1	Powercon out	1
39	8010027404	LADMV-10-005	DMX OUT	1
40	7010200913A	LA2115-10	the side plate (right)	1
41	6121000000	NAC3FCA	powercon plug	1
42	5060202005	XC-DY-36	US power cable 1L SJT 16AWG/3C L=1830MM	1
	5060200011	XC-DY-32	Euro power cable 3*1.50MM L=1830MM	1

GB/T1804-2000 线性尺寸的极限偏差数值

范围(mm)	0.5~3	3~6	6~30	30~120	120~400	400~1000	1000~2000
f (精密)	±0.05	±0.05	±0.1	±0.15	±0.2	±0.3	±0.5
m (中等)	±0.1	±0.1	±0.2	±0.3	±0.5	±0.8	±1.2
e (粗糙)	±0.2	±0.3	±0.5	±0.8	±1.2	±2	±3
未注公差(mm)	±0.1	±0.25	±1	±1.5	±2.5	±4	±8
v (最粗)	±0.5	±1	±1.5	±2.5	±4	±6	±8

名称		折弯	折弯角	喷漆厚度	GB/T1804-2000 线性尺寸的极限偏差数值		
尺寸范围(mm)		0-50	50-300	>15	单边0.08	双边0.12	
未注公差(mm)		±0.1	±0.25	±1	0.02		
广州鹏林照明灯具有限公司 CKC LIGHTING CO.,LTD.							
制图		名称	产品爆炸图		数量: 1	材料: 组件	
校对					涂复:	比例: 1:1/CAD	
审核		图号	L20104-028-BZ		版本	A0	
批准					第 1 页/共 1 页		